

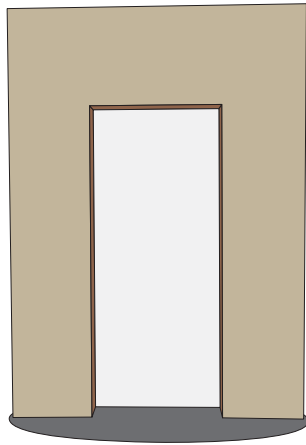

LSC INSTALLATION MANUAL

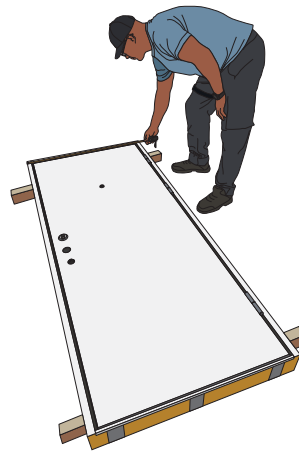

STEP 1. Doors are allowed to be mounted in standard rigid wall 150 mm thickness. Doors without smoke control class S_a/S_{200} can be installed also in flexible walls.



STEP 2. Check the door and the wall opening measurements. The gaps tolerance between the wall and the frame are 5-20 mm. The door frame must be fit in the wall opening to make its external plane align with the wall plane as best as possible.

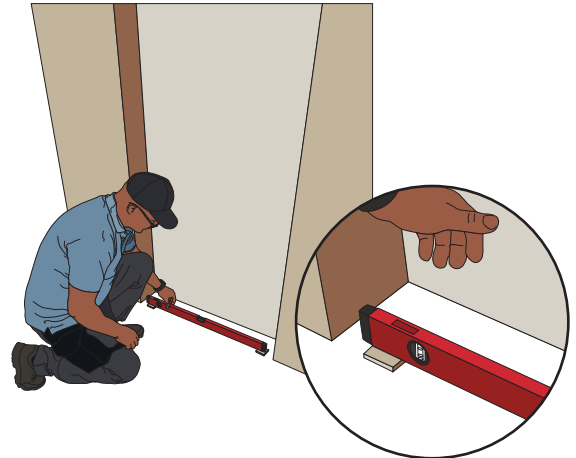

STEP 3. The pad is inserted under the door frame on the side of the hinges (5-10 mm in thickness). The pad is necessary for getting some looseness under the door frame on the side of the locks, which is needed to even the side of the door frame pins.



STEP 4. Fix the door frame in the opening using adjustable bolts or pads.

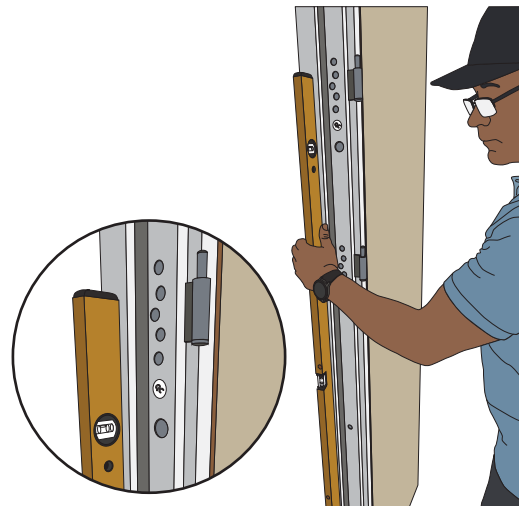

STEP 5. Use a level to even out the hinge side of the door frame (tolerance between the upper and lower corner of the door frame is 2 mm).



STEP 6. Drill the wall through the adjustable hole or installation bolt points in the vertical part of the door frame. For concrete and plasterboard walls - concrete screw $\varnothing 7,5$ mm L-112 mm; for wooden wall - concrete screw $\varnothing 7,5$ mm L-72 mm.

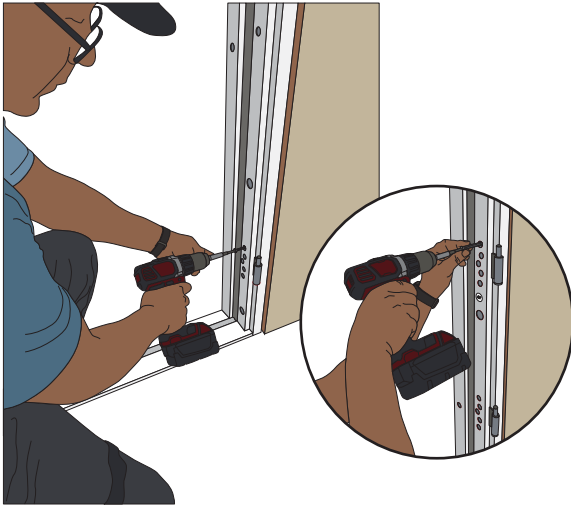

STEP 7. Fix the door frame (hinge side) to the wall using bolts.



STEP 8. Double-check the fixed door frame using a level. Do the checking on the vertical hinge side inside the door frame. Make sure that all hinges are aligned on the same axis.

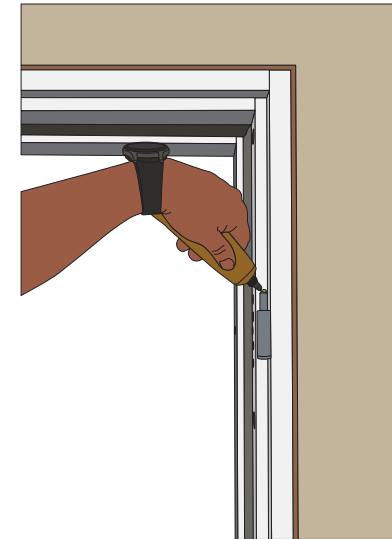

STEP 9. Hinges are lubricated.



STEP 10. Door leaf is hanged on the hinges.

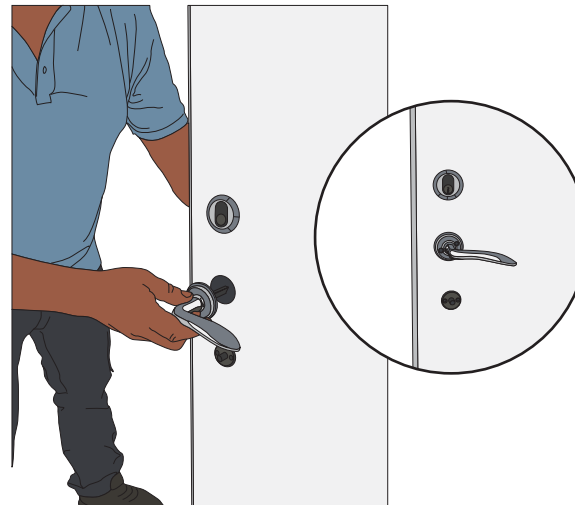

STEP 11. Handle, cylinder* and spinner are installed into the door leaf, the protection of the cylinder is affixed.



STEP 12. Check the closing function and gap seals.

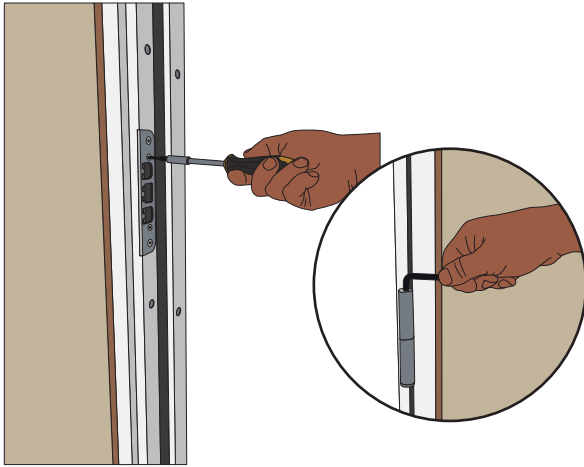

STEP 13. If needed make adjustment of the striking plate and hinges.



STEP 14. Fix the lock side of the door frame to the wall (drill the wall through the adjustable hole or installation bolt points in the vertical part of the door frame).



STEP 15. When both sides of the door frame are fixed in the wall opening, put the gap appropriate pads under the middle and lock side of threshold.



STEP 16. Depending on the product specifications, the gaps between the wall and the jamb are sealed with the fire resistant polyurethane foam "Penosil Premium Fire Rated B1" or with the fire resistant mineral wool class A1 or A2-s1, d0.